

Cast from iOS/Android device

- Press the button on RX to switch ASK nano 4K RX to Airplay/Miracast Mode

From iOS

- See the current mode above the TV graphic on the display/product

1. Connect iOS device to **ASK nano 4K RX** from Wi-Fi Settings.

- Wi-Fi Network: 「ASK nano 4K-XXXXXX」
- Password: 12345678

2. From Quick Settings,select 「Screen Mirroring」 to mirror the display.



From Android

1. Choose [Screen Cast]or [Wireless Projection]on the Android device.
2. Connect to 「ASK nano 4K-XXXXXX」

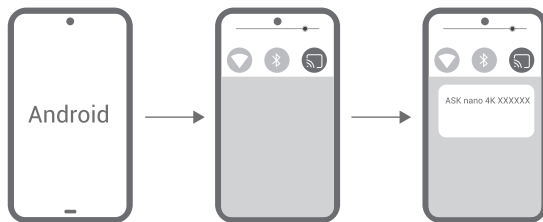

Optional-Connect to Internet

When your IOS or Andriod device need to connect to internet but is not able to use cellular data, such as IPAD or or other tablet, it is necessary to connect your ASK nano 4K RX to internet.

- Check the TV screen and make sure RX is under Airplay/Miracast mode.
- Connect the RX SSID with your smart devices, the SSID and password are shown on the right upper corner of the screen.



1. Open the browser with your phone, and input the IP address shown on the right upper corner of the screen to enter to the ASK nano 4K RX management platform.
- 2.Select the network and connect in the management platform, the RX will link to the network and show the network SSID on the upper right corner of the screen. (To get a better performance, we recommend to connect with 5G router.)
- 3.Connect your iOS/Andriod device to the same network of ASK nano 4K RX.

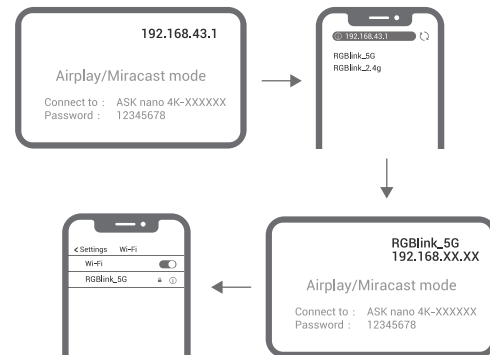

For iOS

From Quick Settings, select Screen Mirroring and choose ASK nano 4K XXXXX-iTV from the device list.



For Android

Search wireless projection device from setting and choose ASK nano 4K-XXXXX.



Specification

Transmitter	
Power	USB-C DC 5V/ 1A Max 3.0W
HDMI	HDMI 2.0/ HDCP 2.2
Supported Input Resolution	3840x2160@24/25/30 1920x1080@24/25/30/50/60 1280x720@50/60
Receiver	
Power	USB-C DC 5V/ 1A Max 3.0W
HDMI	HDMI 2.0
Output Resolution	Up to 3840x2160@60

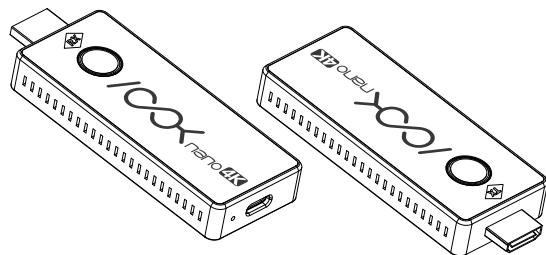

USER MANUAL

Overview

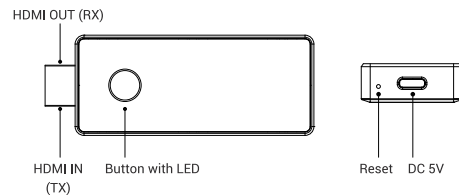

Receiver

Item	Illumination
HDMI OUT	Connect with monitor or projector
LED	To display different status
Button	Short press to switch mode between TX Mode and Airplay/Miracast Mode
USB-C Jack	For power supply

Transmitter

Item	Illumination
HDMI IN	Connect with the HDMI port of the source devices
LED	To display different status
Button	Click to discontinue projection or resume projection
Reset	long press around 5s till red light flash quickly
USB-C Jack	For power supply

In the Box

1 Transmitter&2 Receivers (ASK nano 4K 1T2R)

ASK nano 4K TX	1
ASK nano 4K RX	2
USB A-C Power Cable	3
HDMI Male to Female Extender Cable	3
Micro/Mini HDMI to HDMI Adapter	1

1 Transmitter&1 Receiver (ASK nano 4K 1T1R)

ASK nano 4K TX	1
ASK nano 4K RX	1
USB A-C Power Cable	2
HDMI Male to Female Extender Cable	2
Micro/Mini HDMI to HDMI Adapter	1

Quick Start

Connect the Receiver

1. Connect the RX with HDMI port of display.
2. Connect the USB-C port of RX to the TV USB port through the USB cable for power supply.

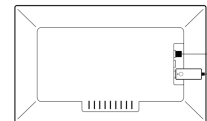

Note: The power supply of RX is about 5V/1A. Please connect the RX with a power adapter if your TV can't supply enough power.

Indicator light of Receiver

RX	Illumination
Flashing Blue	Power on and ready for projection
Static blue	Already in projection

Connect the Transmitter

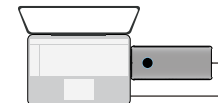

1. Check the TV screen and make sure it is under "TX Mode", if not press the button on ASK nano 4K RX.
2. Connect ASK nano 4K TX to a 5V/1A power adapter or USB 3.0 port of PC by a USB A-C cable.
3. Plug HDMI jack of ASK nano 4K to HDMI output on PC or other source device.
4. Wait and it will connect automatically.

Indicator light of Receiver

TX	Illumination
Static Red	TX system is booting on
Flashing Red	TX is searching for RX
Flashing Blue	Waiting for the connection
Static blue	Connected and start presenting
Purple	No HDMI in